

**1911 BUSINESS LOOP 70 E**

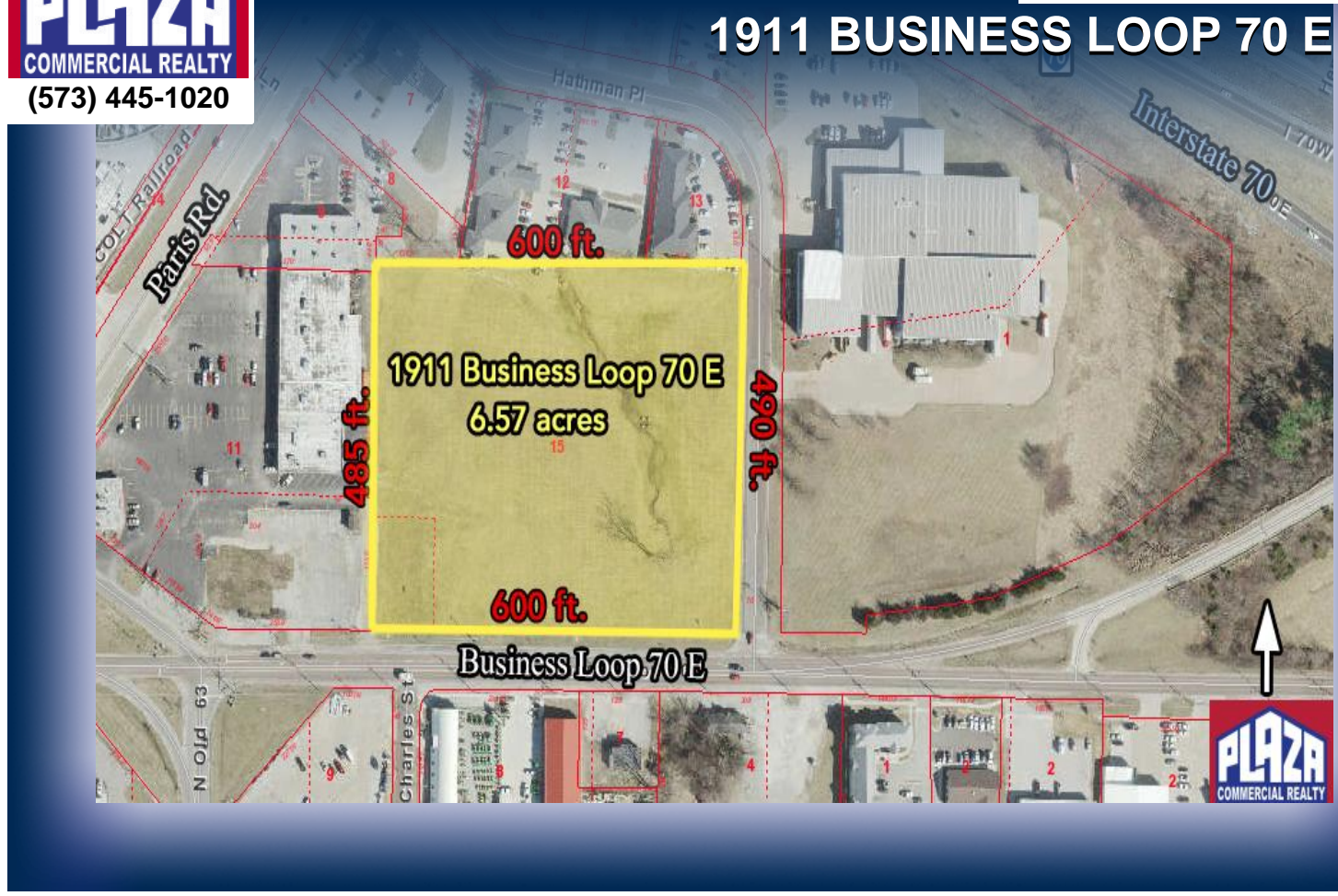

**ADDRESS**

1911 Business Loop 70 E  
Columbia, MO

**PROPERTY TYPE**

Land

**SALE PRICE**

\$1,500,000

**LAND**

6.57 acres

**ZONING**

M-C

**DETAILS**

- 6.57 acres of land at eastern portion of Business Loop 70 E with high visibility and favorable M-C district zoning which allows all retail and office uses and some permitted industrial uses with conditional approval.
- Property is offered for sale in its entirety a \$1,500,000.
- All utilities are to the site to satisfy development requirements.
- Survey is available upon request.
- Easy access to Hwy 63 and I-70 interchange.
- Access drives available to Business Loop 70 and Hathman Dr.
- Close proximity to various business uses.

Paul Land, *SIOR* PaulLand@PlazaCommercialRealty.com  
Mike Grellner, *SIOR* MikeGrellner@PlazaCommercialRealty.com  
Lauren Crosby, *Agent* LaurenCrosby@PlazaCommercialRealty.com

2501 Bernadette Drive  
Columbia, MO 65203  
(573) 445-1020

